

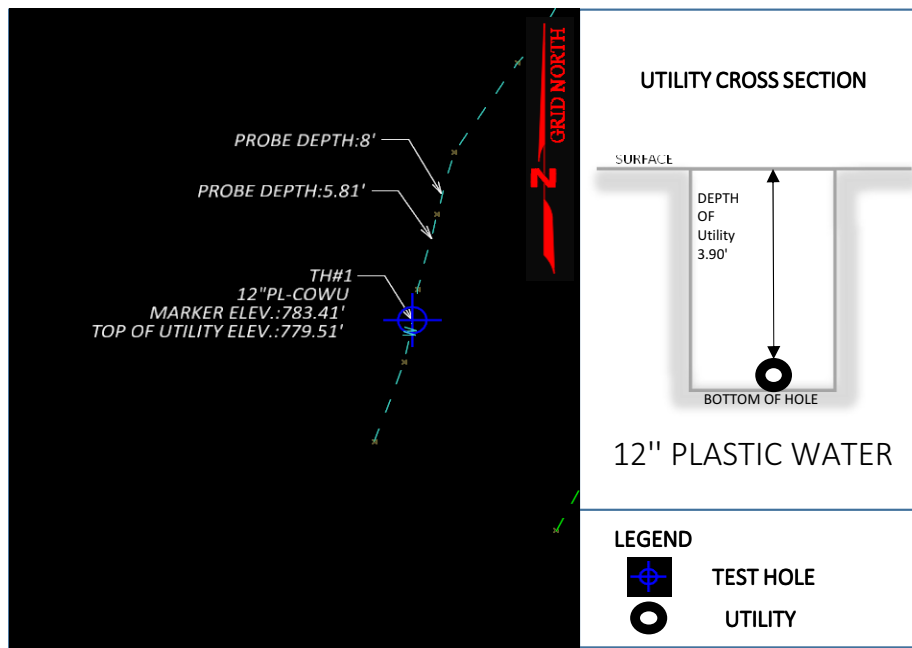

Surveying And Mapping, LLC (SAM)
12480 DeBartolo Drive, Unit F
North Jackson, OH 44451
Office: 330-794-4455

**SUE QUALITY LEVEL A
TEST HOLE #1
WEST UNITY, OH
12" PLASTIC WATER**

Project:	DGL - WIL - 127 - 12.43/15.09 PID 114748	Date Performed:	6/10/2025
SAM, LLC Project #	1025099173	Client:	DGL CONSULTING ENGINEERS, LLC
Project Location:	WEST UNITY, OHIO 43570	Surface Material & Thickness:	NATURAL GROUND
Utility Location:	US 127	Marker Elevation:	783.41
Utility Sta./Offset:	N/A	Surface Condition:	GOOD
Record Utility:	12" PLASTIC WATER	Trench Material:	CLAY
Utility Owner:	CITY OF WEST UNITY	Utility Bedding Material:	CLAY
Contact:	N/A	Utility Found:	12" PLASTIC WATER
Phone/Email:	N/A	Utility Condition:	GOOD
Field Crew:	SR/CM	Utility Depth:	3.90'
Field Conditions:	SUNNY/ WARM		



PROJECT CONTROL

Coordinates shown are based on NAD 83, ODOT LDP Williams County, derived from GPS observations utilizing the Trimble Network..

EXCAVATION CENTERLINE COORD.

NORTHING	362250.56
EASTING	197203.21
TOP ELEV.	779.51

STATE OF OHIO
WAYNE MITTWEDE
S-8535
REGISTERED SURVEYOR

Wayne Mittweide

7/07/2025

Comments



Surveying And Mapping, LLC (SAM)
12480 DeBartolo Drive, Unit F
North Jackson, OH 44451
Office: 330-794-4455

SUE QUALITY LEVEL A
TEST HOLE #2
WEST UNITY, OH
12" PLASTIC WATER

Project:	DGL - WIL - 127 - 12.43/15.09 PID 114748	Date Performed:	6/11/2025
SAM, LLC Project #	1025099173	Client:	DGL CONSULTING ENGINEERS, LLC
Project Location:	WEST UNITY, OHIO 43570	Surface Material & Thickness:	NATURAL GROUND
Utility Location:	US 127	Marker Elevation:	782.37
Utility Sta./Offset:	N/A	Surface Condition:	GOOD
Record Utility:	12" PLASTIC WATER	Trench Material:	CLAY
Utility Owner:	CITY OF WEST UNITY	Utility Bedding Material:	CLAY
Contact:	N/A	Utility Found:	12" PLASTIC WATER
Phone/Email:	N/A	Utility Condition:	UNKNOWN
Field Crew:	SR/CM	Utility Depth:	8.78'
Field Conditions:	SUNNY/ WARM		

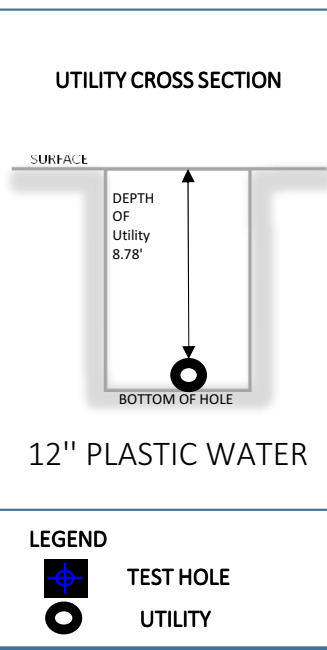
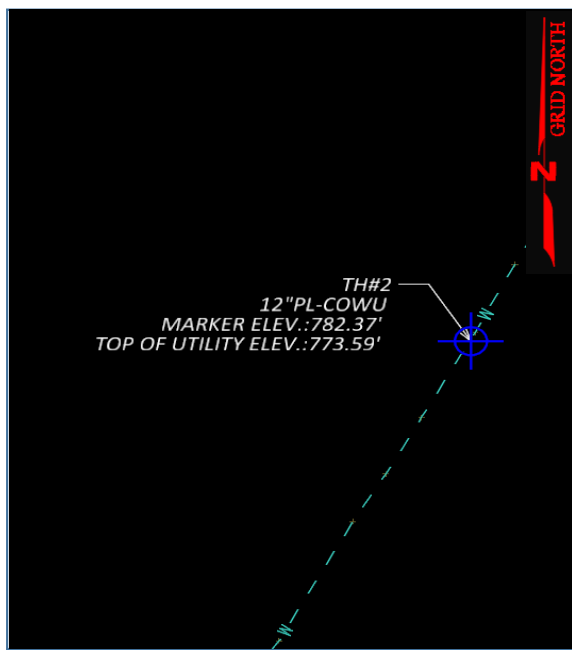

PROJECT CONTROL

Coordinates shown are based on NAD 83, ODOT LDP Williams County, derived from GPS observations utilizing the Trimble Network..

EXCAVATION CENTERLINE COORD.

NORTHING	362379.19
EASTING	197265.44
TOP ELEV.	773.59

STATE OF OHIO

WAYNE MITTWEDE

S-8535

REGISTERED SURVEYOR

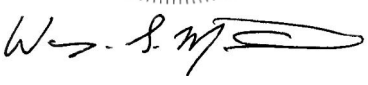

7/7/2025

Comments

1. Utility not exposed due to copious amounts of groundwater. Utility location and depth confirmed with probe.



Surveying And Mapping, LLC (SAM)
12480 DeBartolo Drive, Unit F
North Jackson, OH 44451
Office: 330-794-4455

SUE QUALITY LEVEL A
TEST HOLE #3
WEST UNITY, OH
8" PLASTIC SANITARY FORCE
MAIN/12" PLASTIC STORM
SEWER

Project:	DGL - WIL - 127 - 12.43/15.09 PID 114748	Date Performed:	6/11/2025
SAM, LLC Project #	1025099173	Client:	DGL CONSULTING ENGINEERS, LLC
Project Location:	WEST UNITY, OHIO 43570	Surface Material & Thickness:	NATURAL GROUND
Utility Location:	US 127	Marker Elevation:	785.52
Utility Sta./Offset:	N/A	Surface Condition:	GOOD
Record Utility:	8" PLASTIC SANITARY FORCE MAIN/12" PLASTIC STORM SEWER	Trench Material:	SAND
Utility Owner:	CITY OF WEST UNITY	Utility Bedding Material:	SAND
Contact:	N/A	Utility Found:	8" PLASTIC SANITARY FORCE MAIN/12" PLASTIC STORM SEWER
Phone/Email:	N/A	Utility Condition:	UNKNOWN
Field Crew:	SR/CM	Utility Depth:	7.31'/2.36'
Field Conditions:	SUNNY/ WARM		

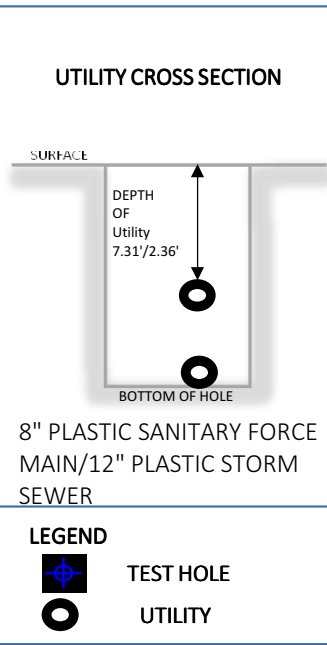
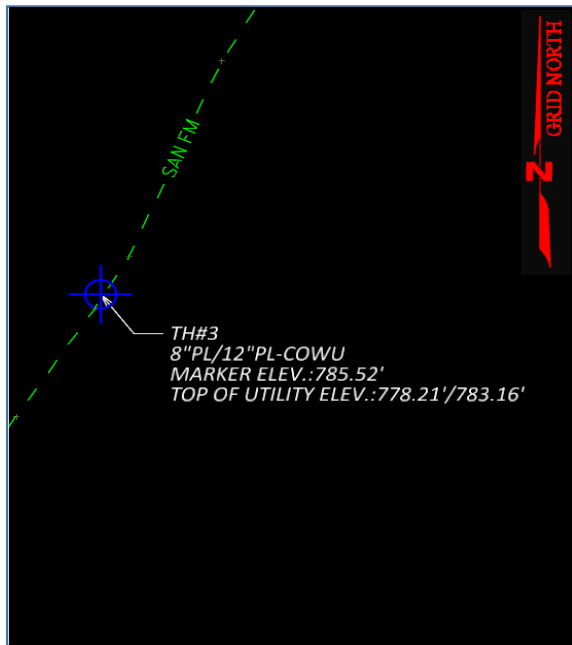

PROJECT CONTROL
Coordinates shown are based on NAD 83, ODOT LDP Williams County, derived from GPS observations utilizing the Trimble Network..

EXCAVATION CENTERLINE COORD.
NORTHING 362271.76
EASTING 197273.83
TOP ELEV. 778.21'/783.16'



Wayne Mittleweide

7/7/2025

Comments